

- ① Remove the cover.  
Loosen the screws on the diffuser and open it.

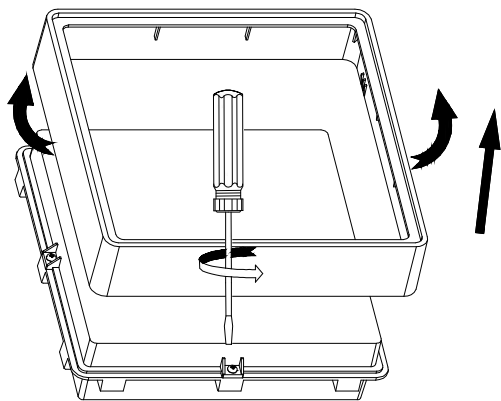

TOOL Screwdriver

- ② Loosen the screws on the LED board.  
Remove the reflector.

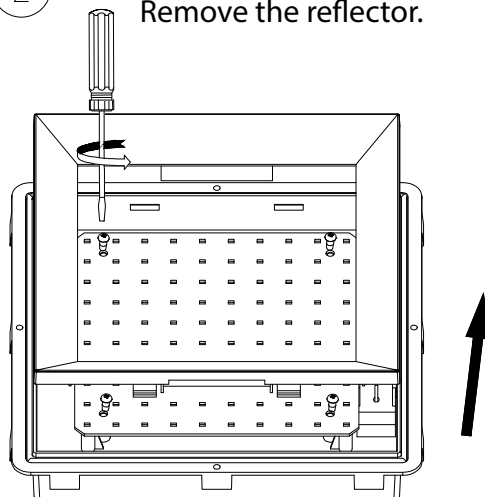

TOOL Screwdriver

- ③ Remove the red  
and black wires  
from the driver.

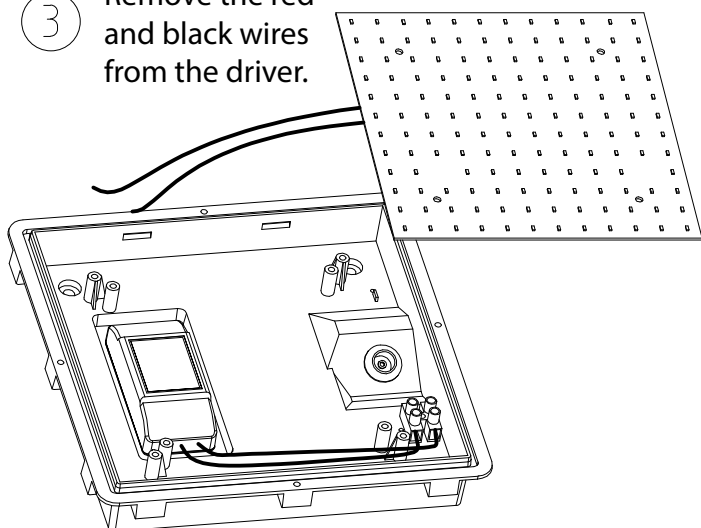

TOOL Screwdriver

- ④ Change the LED board.

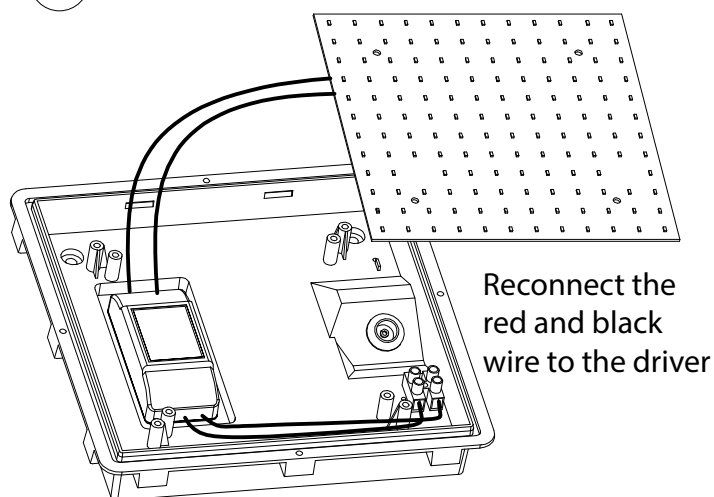

TOOL Screwdriver

- ⑤ Fix the LED board with screws.  
Reinstall the reflector.

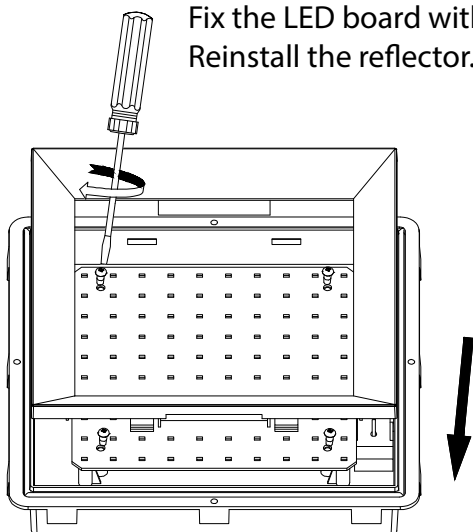

TOOL Screwdriver

- ⑥ Fix the diffuser with screws and click the cover  
in place.

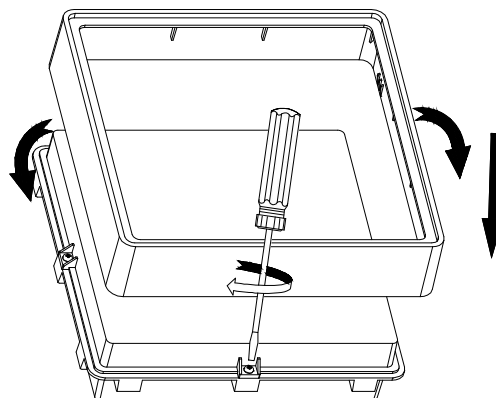

TOOL Screwdriver