

- ① Loosen the screws on the PC cover and open it.

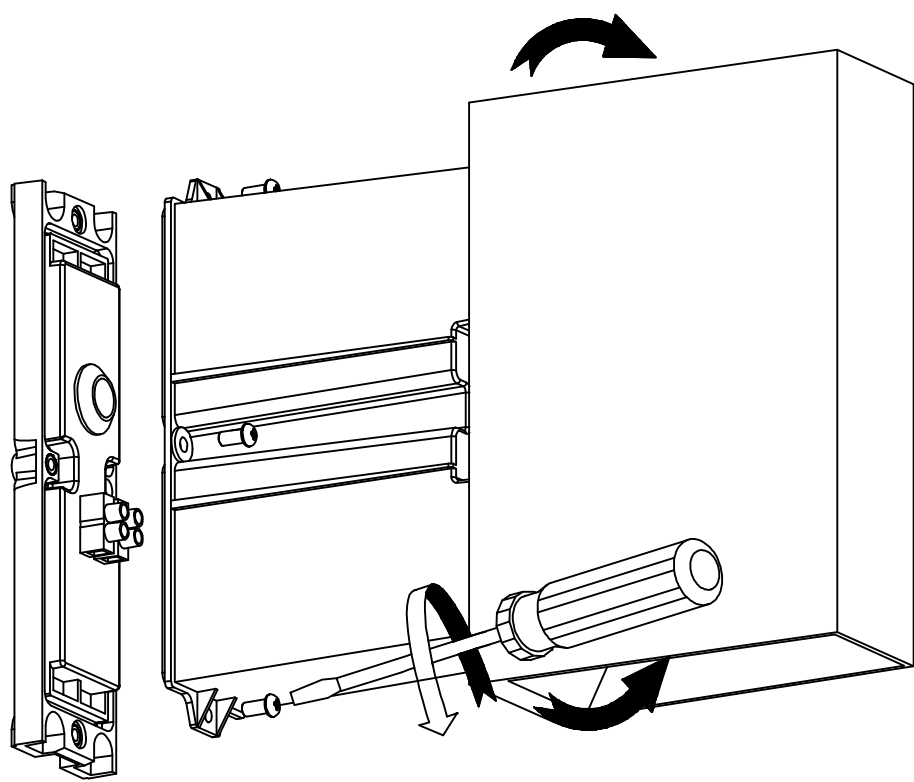

Open the lamp cover

**TOOL** Screwdriver

- ② Take out the LED module from the cover

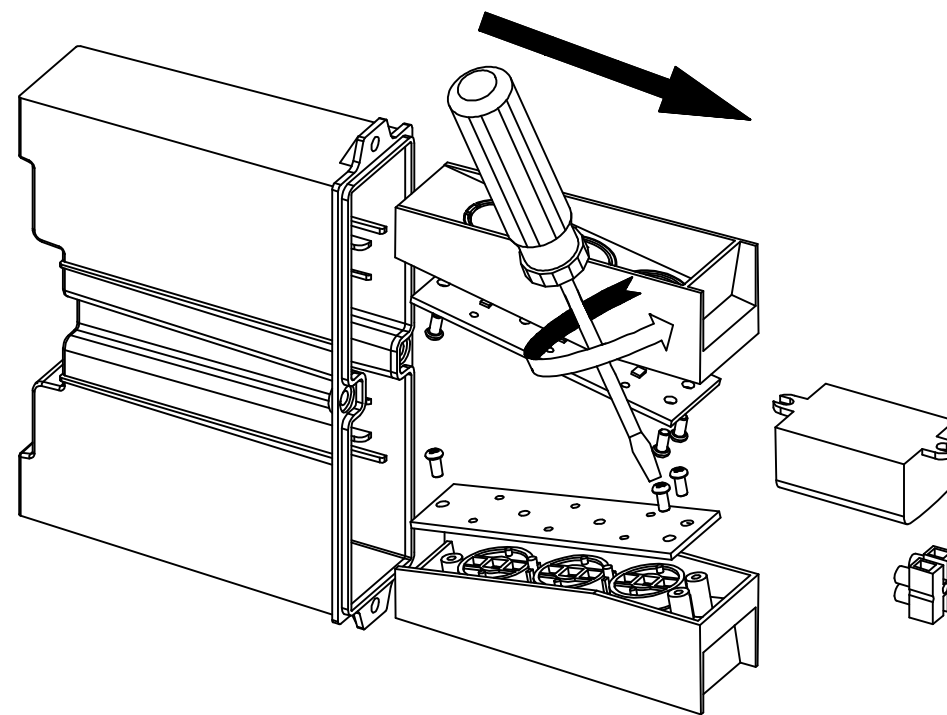

Loosen the screws on the LED board

**TOOL** Screwdriver

- ③ Take out the red and black wire of the driver from the LED module

Take out the blue and brown wire from the terminal block

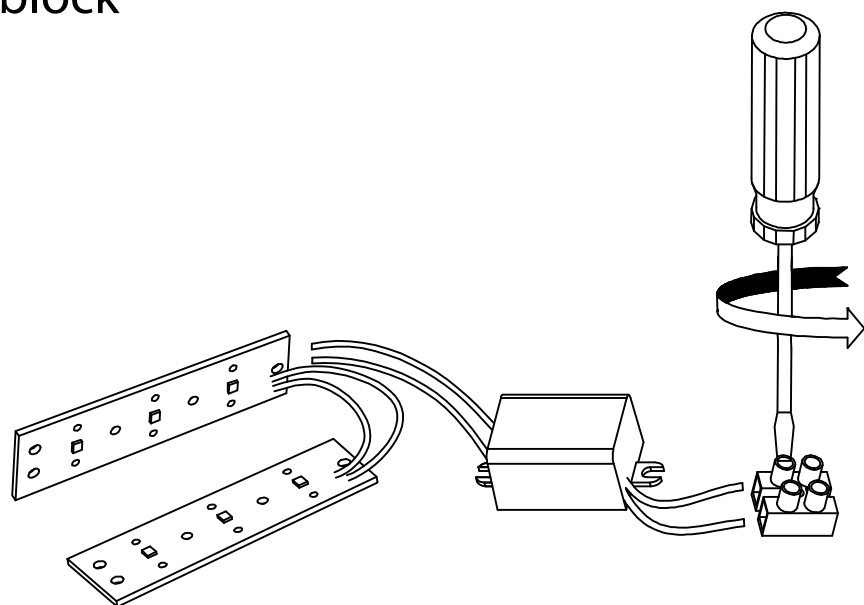

**TOOL** Screwdriver  
Electric soldering iron

- ④ Re-solder the red and black wire of the new driver on the LED module

Connect the blue and brown wire to the terminal block

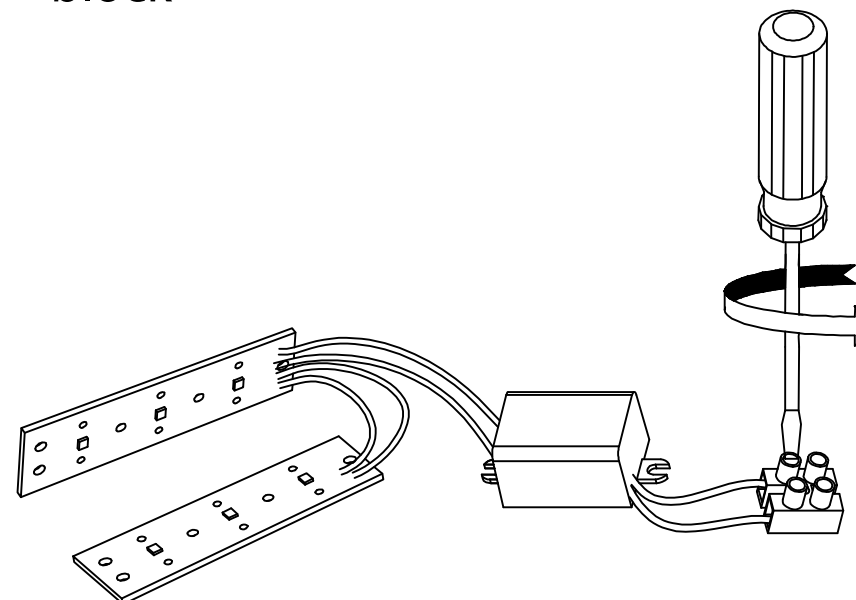

**TOOL** Screwdriver  
Electric soldering iron

- ⑤ Fix the LED board with screws to the lens module. Re-attach the LED module and new driver.

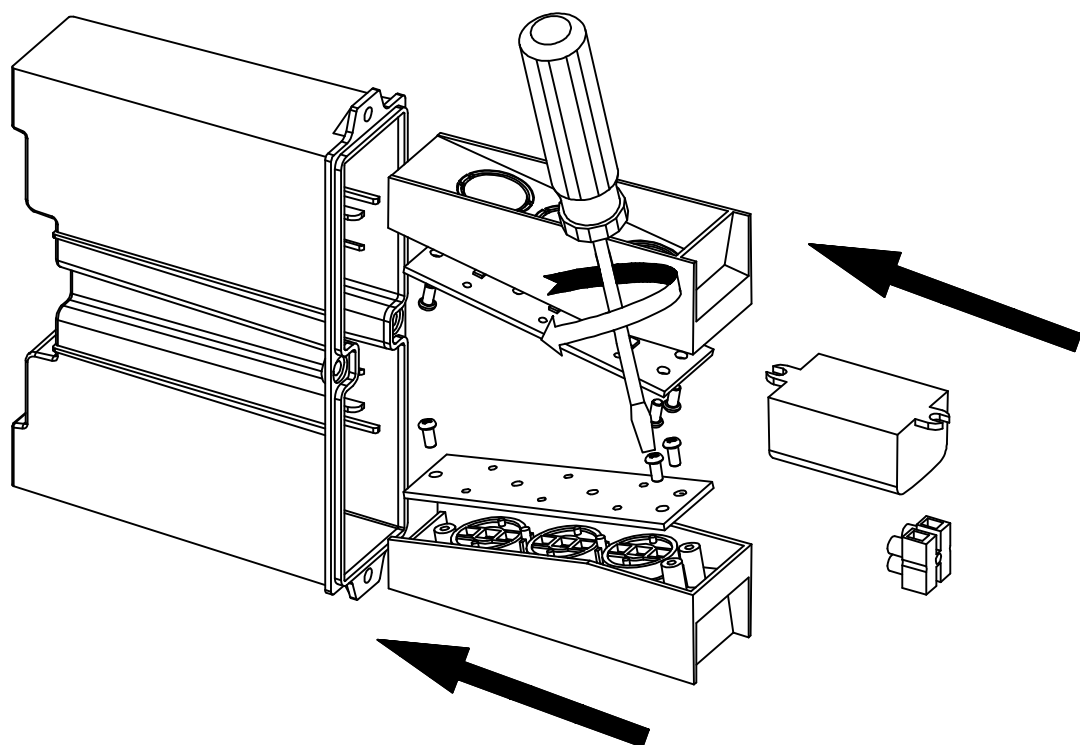

**TOOL** Screwdriver

- ⑥ Fix the PC cover with screws and re-attach the lamp cover.

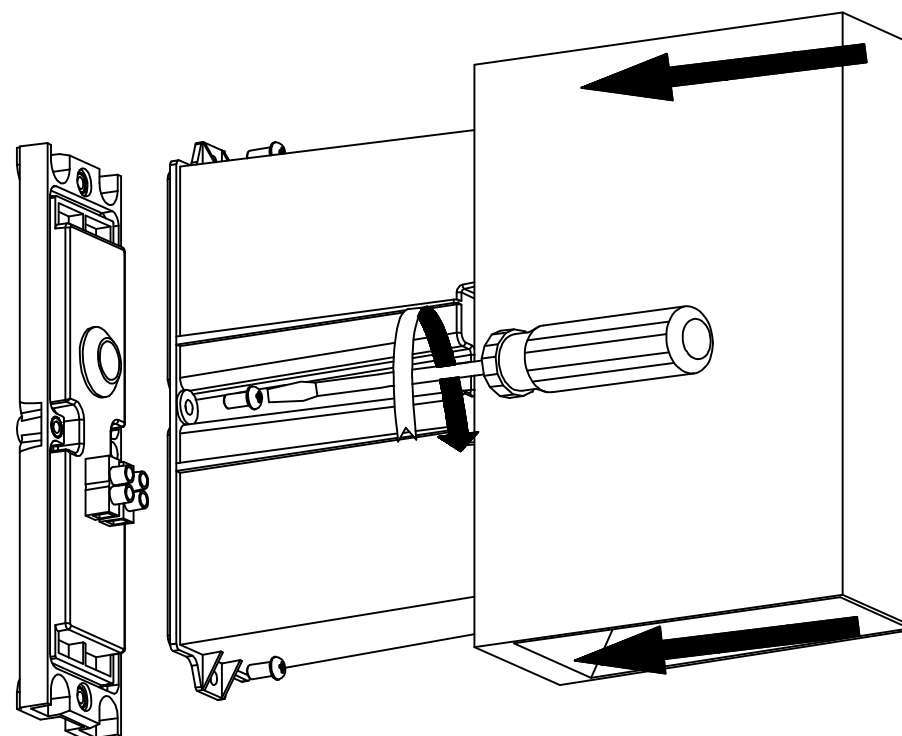

**TOOL** Screwdriver