

- ① Loosen the screws on the PC cover and open it
Open the lamp cover

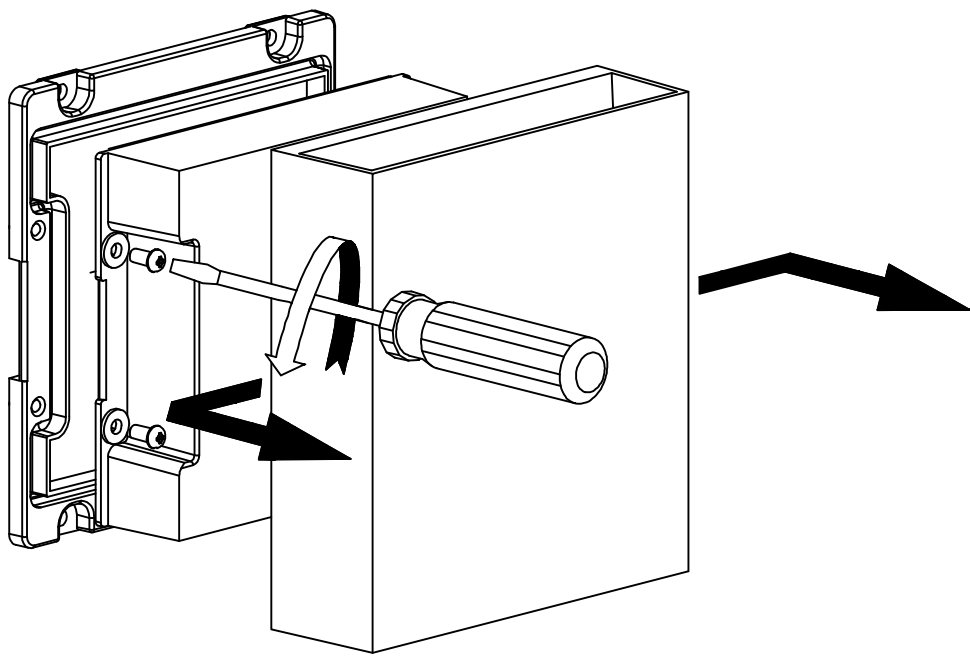

TOOL Screwdriver

- ② Loosen the screws on the driver.
Take out the LED module from the PC cover module.

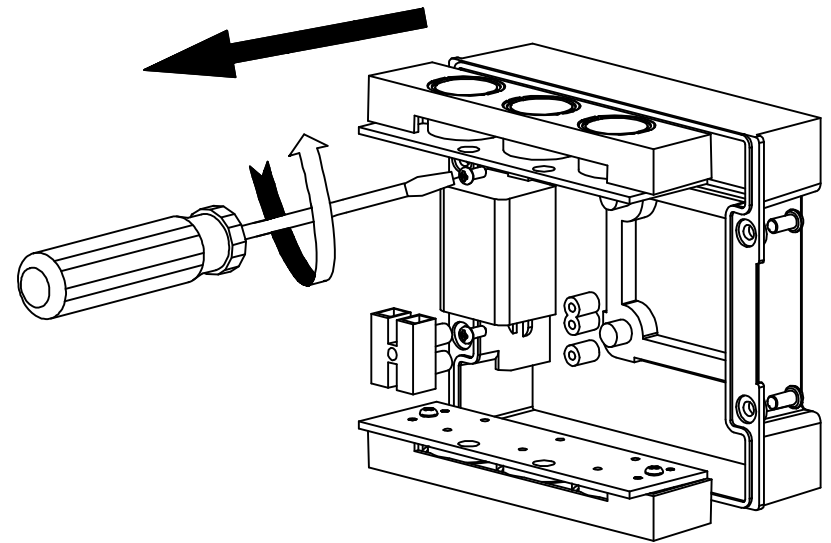

TOOL Screwdriver

- ③ Loosen the screws on the LED board

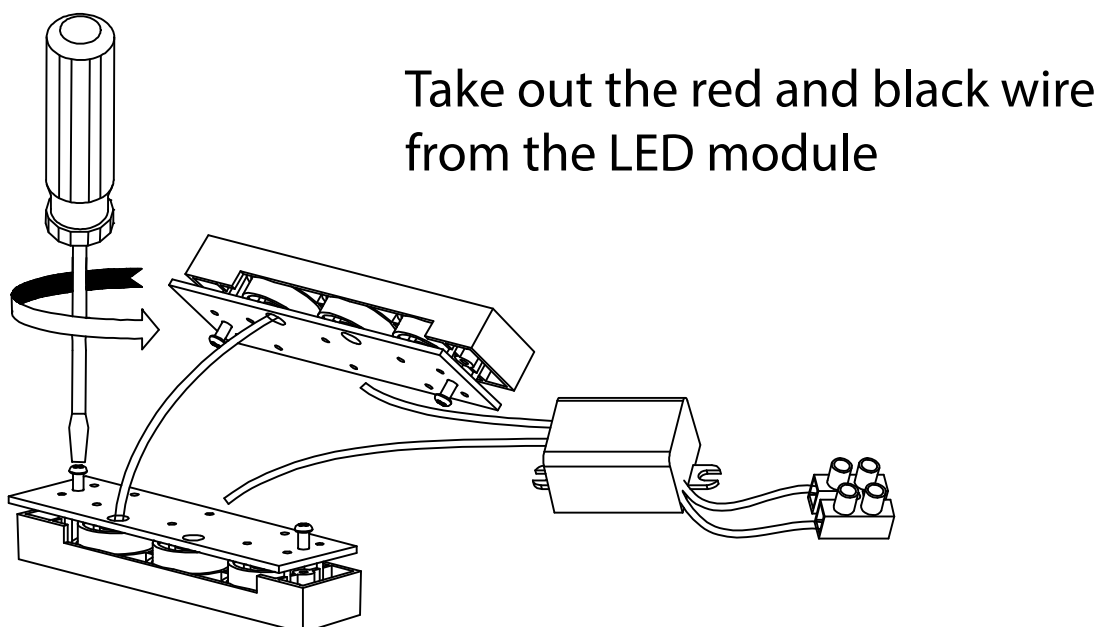

TOOL Screwdriver
Electric soldering iron

- ④ Re-solder the red and black wire
on the new LED module.
- Fix the new LED board with screws
to the lens module.

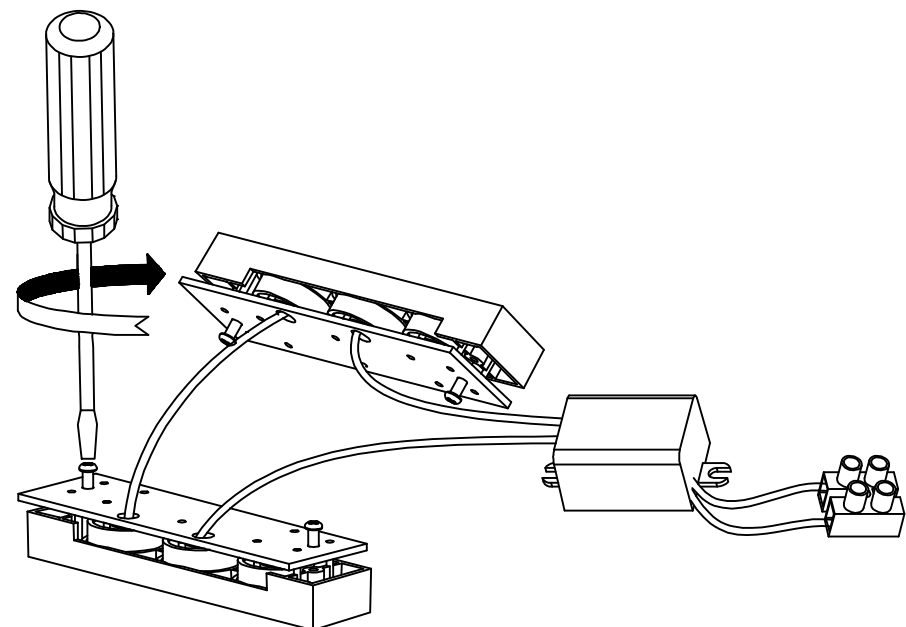

TOOL Screwdriver
Electric soldering iron

- ⑤ Fix the driver with screws.
Attach the new LED module.

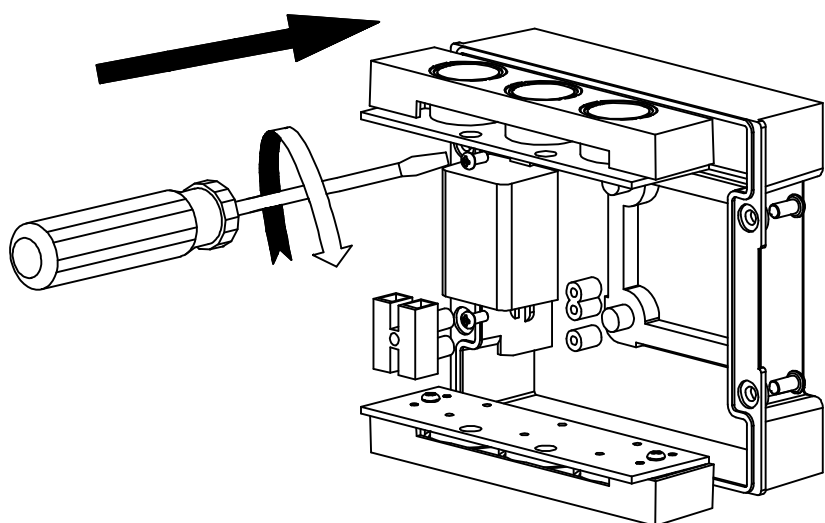

TOOL Screwdriver

- ⑥ Fix the PC cover with screws and attach
the lamp cover

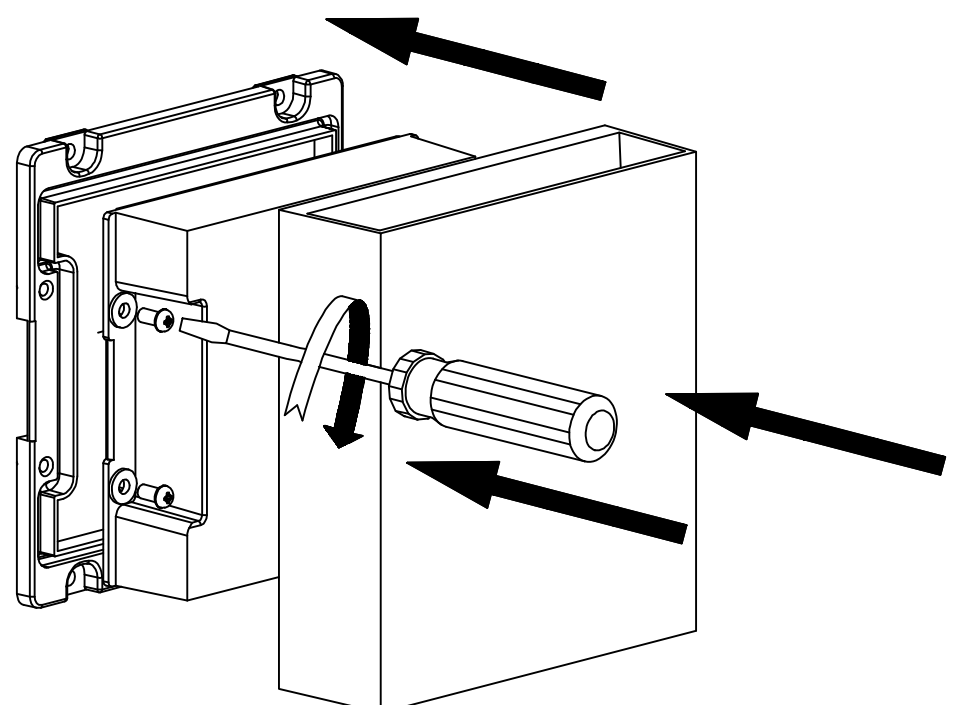

TOOL Screwdriver