

1

Take out the blue and brown wire in the lamppost from the terminal block

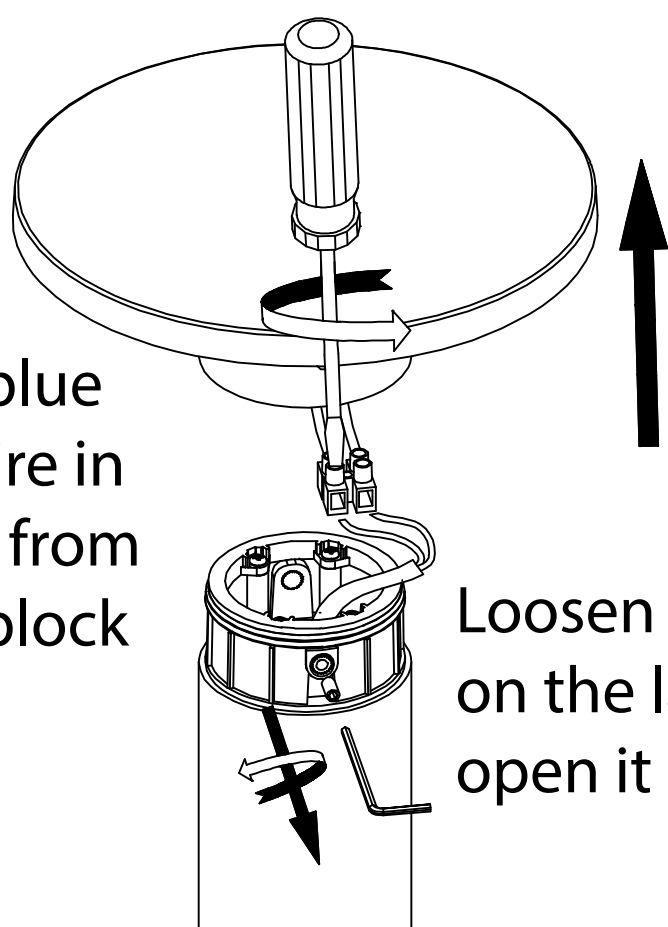

Loosen the screws on the lamp and open it

TOOL Wrench
Screwdriver

2

Loosen the screws and take out the lamp lid



TOOL Screwdriver

3

Loosen the screws on the LED module

Remove the blue and brown wires from the terminal block

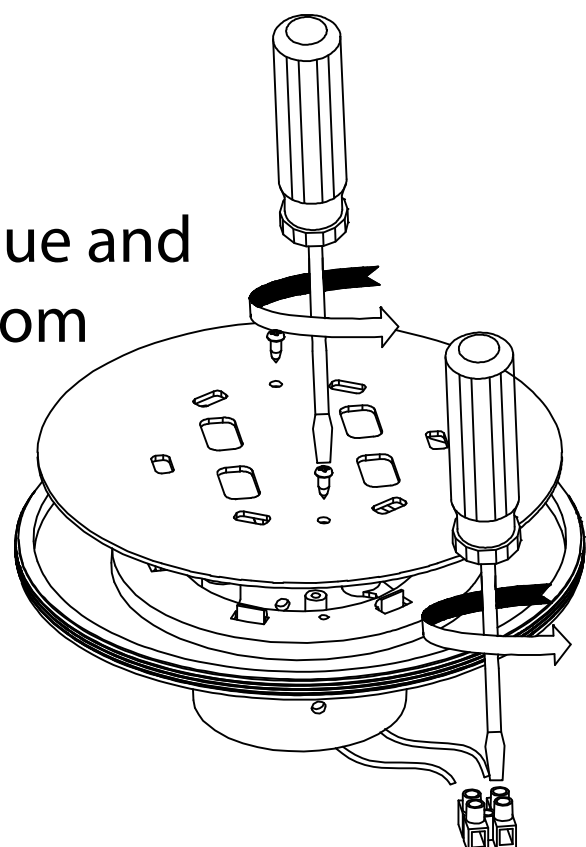

TOOL Screwdriver

4

Fix the new LED module with screws to the PC cover module

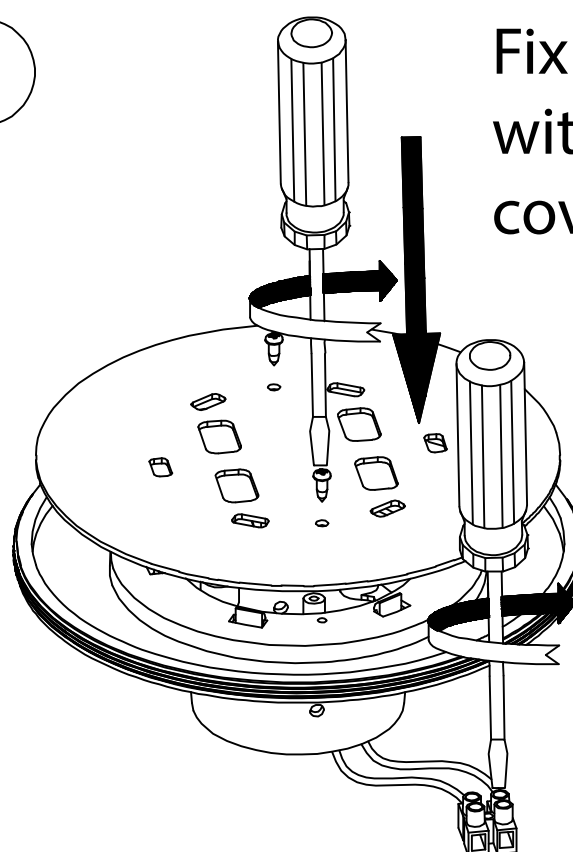

Connect the blue and brown wires to the terminal block

TOOL Screwdriver

5

Fix the lamp lid with screws

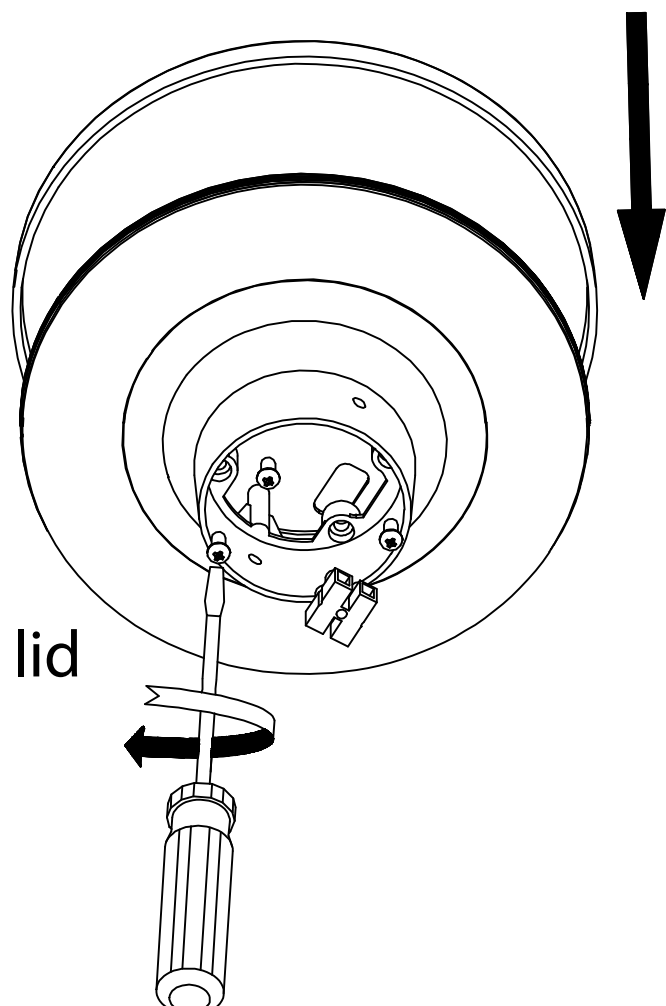

TOOL Screwdriver

6

Connect the blue and brown wires to the terminal block

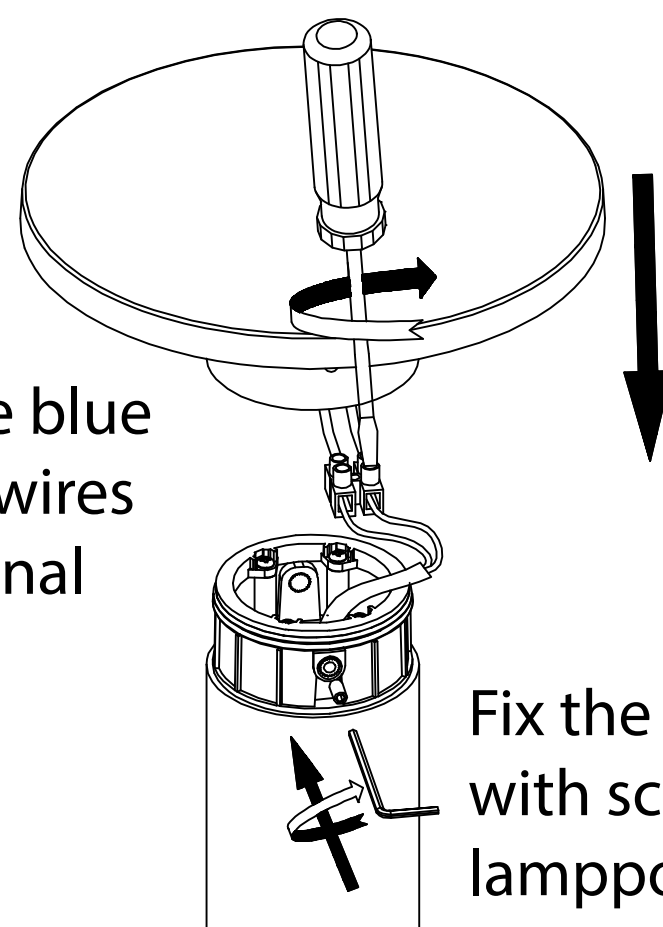

Fix the lamp with screws to the lamppost

TOOL Wrench
Screwdriver